

Better Homes and Gardens Special Interest Editions.

Quick Updates  
**BIG IMPACT**  
p.14

# KITCHEN + BATH IDEAS

## Pretty & Practical 17 Inviting Looks

**79 EXPERT TIPS:**

- > Get More for Your Money p. 50
- > Plan Better Storage p. 32
- > Add Style to a Small Bath p. 44

NOVEMBER/DECEMBER 2012  
Display until December 11  
BHG.com/KitchenBath



## small bath



## AGE OF WONDER

A young bath in Atlanta grows up with sophistication.

writer **LYNNE MEREDITH GOLODNER**  
photographer **EMILY J. FOLLOWILL**  
field editor **LISA MOWRY**

**ALTHOUGH THERE WERE IDEAS** all around—in the blues and oranges of the nearby bedroom's decor and the flourishing foliage outside the bathroom window—nothing clicked for designer Karen Ferguson's client.

The Atlanta homeowner was searching for a new look—something to mature the white-and-neon-green checked walls and flowery vanity of her daughter's bathroom. "She was ready for a place where guests of

all ages felt comfortable," Ferguson says. Familiar with her client after more than a decade of working together, Ferguson knew she wanted a look that would feel luxurious in the small 11×5-foot space.

Ferguson and her client were scouring a tile showroom when inspiration struck: a standout marble with a green tint and irregular veining. "The homeowner fell in love," Ferguson says, and the bath's new design unfolded from there. Ferguson used the showstopping Sofia marble as the base for the room, covering the floor, wainscoting, tub and shower surround, even part of the ceiling.

A shimmery glass tile breaks up the long runs of marble. Forming a band that wraps the room and making up part of a stunning focal-point mosaic in the shower, the iridescent green, blue, and amber hues of the tile complement the coloring of the natural stone. Antique-brass hardware—from the sink and shower fixtures to the vanity pulls and sconces—warms up the cool marble.

The vanity, made of English bur oak, lends a natural texture to the small space. Its furniturelike structure embraces the grandeur of the room's dominant marble while adding an openness that a built-in wall-width vanity would not. A nod to the nearby bedroom, the arched mirror and shaded sconces reflect the home's casual French style.

It's these little details that balance the big impact of the opulent marble surfaces. With rich materials and a grand presentation, this once-adolescent bath is now delightfully grown up. **KBI**

RESOURCES BEGIN ON PAGE 134.

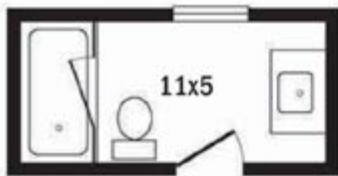

**OPPOSITE:** A stand-alone vanity helps the room feel larger. **TOP LEFT:** The sconces complement the brass piping details on the arched mirror. **TOP RIGHT:** Evoking the look of bamboo, the furniturelike vanity offers a warm contrast to the marble's cool tones. **LEFT:** A glass enclosure and an undermount tub satisfy the homeowner's preference for clean design. The full-wall tile mosaic is a dramatic focal point. **ABOVE:** A band of iridescent glass tile breaks up the expanse of marble. The soft curves and antique finish of the faucet enhance the room's elegant look.

Many of the products in our featured kitchens and baths are available for purchase and are listed here.

**[T] TO THE TRADE ONLY** These items or services are not available to the general public. Contact a design professional for help.

**[P] PAINT COLOR** Because of the magazine printing process, paint colors depicted on our pages may vary slightly from manufacturers' colors. Use paint color names or numbers, when provided, as a starting point. To get the exact color you see in the magazine, take the page to a paint retailer for matching.



**11-13 WHAT'S NEW**

**Wallpaper:** background Mizoram in green, roll Buccini in gold—Thibaut; 800/223-0704; [thibautdesign.com](http://thibautdesign.com). **Cabinet door**—Multi Arched 7-Lite Mullion; Plain and Fancy Cabinetry; 800/447-9006; [plainfancycabinetry.com](http://plainfancycabinetry.com). **Hardware** Queensway knob in satin gold, Queensway pull in dark brass, Kensington knob in dark brass—Notting Hill Decorative Hardware; 262/248-8890; [nottinghill-usa.com](http://nottinghill-usa.com). **Dishes** Harlequin Butterfly Bloom ceramic teapot, Harlequin Butterfly Bloom blue peony cup and saucer—Wedgwood; 877/900-9973; [na.wwrld.com](http://na.wwrld.com).



**35-37 10 THINGS TO LOVE**

**Appliances**—Sub-Zero, Inc.; 800/222-7820; [subzero.com](http://subzero.com). **Vent hood**—Viking Range Corp.; 888/845-4641; [vikingrange.com](http://vikingrange.com). **Cabinetry** custom; **countertops:** island Calacatta marble, **perimeter** white oak; **flooring** painted hardwoods—check with local suppliers. **Sink** Quatro Alcove—Whitehaus Collection; 800/527-6690; [whitehauscollection.com](http://whitehauscollection.com). **Faucet**—Hansgrohe; 800/334-0455; [hansgrohe-usa.com](http://hansgrohe-usa.com). **Barstools**—Design Within Reach; 800/944-2233; [dwr.com](http://dwr.com). **Paint** Paper White—Benjamin Moore; 888/236-6667; [benjaminmoore.com](http://benjaminmoore.com) [P]. **Mirror** Venetian antique—check with local antiques dealers.

[boschappliances.com](http://boschappliances.com). **Microwave**—Daewoo; [daewooelectronics.co.uk](http://daewooelectronics.co.uk). **Cabinetry**—Greenwalt & Sons Custom Woodworks; 404/271-5179; [greenwaltandsons.com](http://greenwaltandsons.com). **Cabinetry hardware**—Restoration Hardware; 800/910-9836; [restorationhardware.com](http://restorationhardware.com). **Countertops**—Intown Design; 404/812-3820; [intowndesigninc.com](http://intowndesigninc.com). **Faucet**—KWC Faucets, Inc.; 888/592-3287; [kwcfaucets.com](http://kwcfaucets.com). **Washer, dryer**—LG Electronics USA, Inc.; 866/473-5554; [lg.com](http://lg.com). **Lighting:** **pulley pendant**—Architects & Heroes; 512/371-7575; [archhero.com](http://archhero.com); **lantern pendants**—Quoizel; 631/273-2700; [quoizel.com](http://quoizel.com). **Paint:** **cabinetry** Pavestone; **walls** Fleur de Sel—The Sherwin-Williams Co.; 800/474-3794; [sherwin-williams.com](http://sherwin-williams.com) [P].



**44-45 SMALL BATH**

**Architect**—William H. (Bill) Harrison, AIA; **Interior designer**—Karen Ferguson, ASID, Harrison Design Associates; 404/365-7760; [harrisondesignassociates.com](http://harrisondesignassociates.com). **Cabinetry** Brighton sink base in English Burr Oak; **hardware**—J. Tribble Antiques; 888/652-6116; [jtribbleantiques.com](http://jtribbleantiques.com). **Mirror**—Shades of Light; 800/262-6612; [shadesoflight.com](http://shadesoflight.com). **Sink** Kathryn; **toilet** Kathryn comfort height—Kohler Co.; 800/456-4537; [us.kohler.com](http://us.kohler.com). **Shower fixtures, sink faucet** Chesterfield—Newport Brass, a division of Brasstech; 949/417-5207; [brasstech.com](http://brasstech.com). **Tile:** **wall, floor** Sofia; **glass tiles** Oceanside mosaic in Sandstone Iridescent—Walker Zanger; 877/611-0199; [walkerzanger.com](http://walkerzanger.com). **Sconces** Abington—Hudson Valley Lighting, Inc.; 800/814-3993; [hudsonvalleylighting.com](http://hudsonvalleylighting.com).



**40-43 SMALL KITCHEN**

**Architect**—Ili Nilsson, NCARB, NCIDQ; **project manager**—Luly Melarti, TerraCotta Properties; 404/377-0906; [terracottaproperties.com](http://terracottaproperties.com). **Range, refrigerator**—Kenmore; 888/536-6673; [kenmore.com](http://kenmore.com). **Vent hood**—Arietta; 866/570-6401; [ariettakitchenhoods.com](http://ariettakitchenhoods.com). **Dishwasher**—Bosch; 800/866-2022;

**DAILY SWEEPSTAKES, PAGE 8**

No purchase necessary to enter or win. Subject to Official Rules and entry at [BHG.com/Win](http://BHG.com/Win). There will be one Daily Giveaway Sweepstakes per day. Entries for each daily sweepstakes must be received by 11:59 p.m., E.T. Open to legal residents of the 50 United States, and the District of Columbia, 21 years or older. One entry per e-mail address per day. Online entry only. Void where prohibited. Sponsor: Meredith Corporation.